

- When the interval between flights is short and the engine is still hot, with a cowled installation over heating symptoms may occur due to lack of air circulation. In this case allow the engine to fully cool down (in hot weather, it may take more than one hour), or run the engine at idle for four or five minutes.

#### ■ Maintenance after the day's flights

Please pay attention to the matter described below to ensure that your engine serves you well in regard to performance, reliability and long life.

- Check the tightening of each screw, especially engine installation screws and silencer installation screws each time. Also, for the first several flights, tighten the screws after each flight.
- As previously mentioned, it is vitally important to avoid operating the engine in conditions where dust, distributed by the propeller, may be deposited on the engine and enter its working parts.
- With a gasoline engine rust hardly occurs. Check the exterior to make sure there is nothing wrong and wipe off any oil res.
- Fill the carburetor with fuel at the conclusion of a day's flying. (Pay careful attention to fire and ignition source when carrying and storing the model.) If the engine is stored without filling the carburetor, with fuel the inside parts will dry out and not work properly at the next running. If the engine quits out of fuel, refill the carburetor with fuel.

#### ■ O.S. GENUINE PARTS & ACCESSORIES

##### ● PROPELLER LOCKNUT SET FOR SPINNER

5/16"-M4 (45910200) 5/16"-M5 (45910300)

##### ● LOCK WASHER (10sets) ● SUPER FILTER

M5 (55500004) (S) (72403051)

##### ● NON-BUBBLE WEIGHT (S) (71531010) ● BLIND NUT (10pcs.)

M5 (79870050)

##### ● M5 STAND OFF ENGINE MOUNTS (4pcs.)

- 1/4" (6.4mm) (74003510)
- 1-1/4" (31.8mm) (74003550)
- 1/2" (12.7mm) (74003520)
- 1-1/2" (38.1mm) (74003560)
- 3/4" (19.1mm) (74003530)
- 1-3/4" (44.5mm) (74003570)
- 1" (25.4mm) (74003540)
- 2" (50.8mm) (74003580)

The specifications are subject to alteration for improvement without notice.

#### ■ THREE VIEW DRAWING

Dimensions (mm)

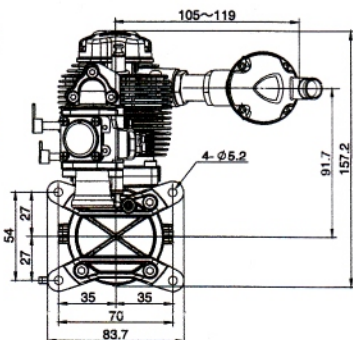
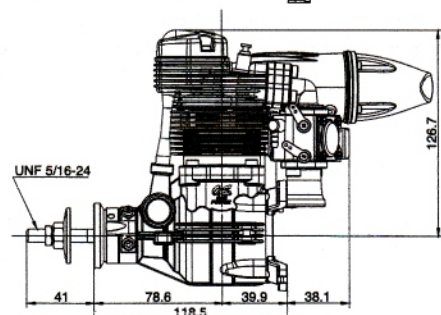
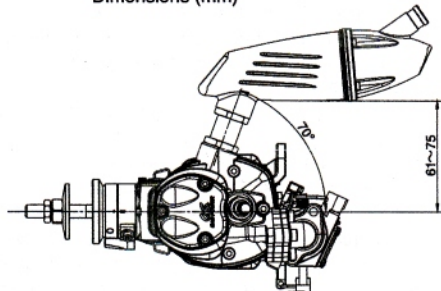

#### ■ ENGINE EXPLODED VIEW

\* Type of screw

C...Cap Screw

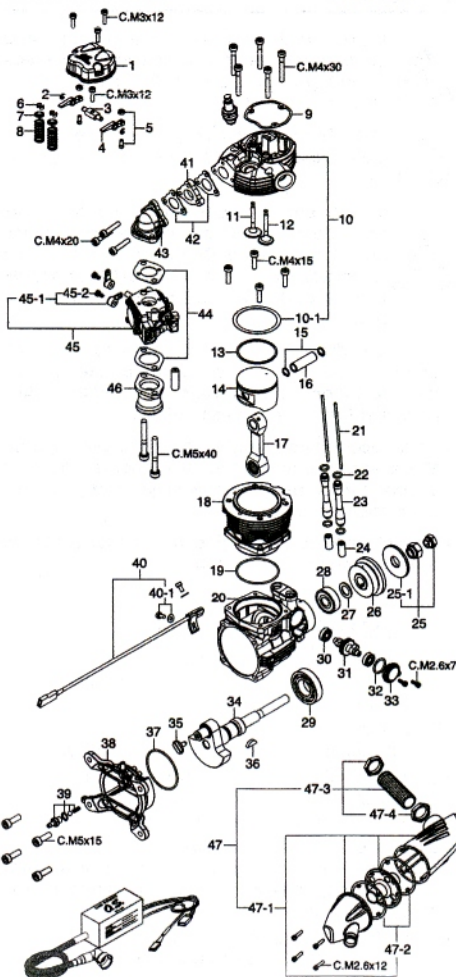

#### CAP SCREW SETS (10pcs./sets)

Code No.	Size	Pos. used in an engine
79871020	M2.6x7	Cam Cover Retaining Screw (2pcs.)
79871040	M2.6x12	Silencer Assembly Screw (4pcs.)
79871140	M3x12	Rocker Cover & Rocker Support Retaining Screw (4pcs.)
79871415	M4x15	Cylinder Retaining Screw (4pcs.)
79871420	M4x20	Intake Manifold Retaining Screw (3pcs.)
79871430	M4x30	Cylinder Head Retaining Screw (5pcs.)
79871515	M5x15	Cover Plate Retaining Screw (4pcs.)
79871540	M5x40	Carburetor Retaining Screw (2pc.)

#### Specifications

■ Displacement	39.96 cc / 2.439 cu.in.
■ Bore	40.0 mm / 1.575 in.
■ Stroke	31.8 mm / 1.252 in.
■ Practical R.P.M.	1,800-9,000 r.p.m.
■ Output	3.8 ps / 3.75 hp / 8,600r.p.m.
■ Weight	1,170 g / 41.27 oz. (Engine) 113 g / 3.99 oz. (Silencer) 95 g / 3.35 oz. (Ignition module)

#### ■ ENGINE PARTS LIST

No.	Code No.	Description
1	49404200	Rocker Cover
2	45761600	Rocker Arm Retainer (2pcs./1pair)
3	49464000	Rocker Support
4	42561100	Rocker Arm (1pc.)
5	44561200	Tappet Adjusting Screw (1pair)
6	45560410	Split Cotter (2pcs./1pair)
7	49460400	Valve Spring Retainer (1pc.)
8	49460200	Valve Spring (1pc.)
9	49414300	Rocker Cover Gasket
10	49404100	Cylinder Head (W/Gasket)
10-1	49404160	Head Gasket (1pc.)
11	49460100	Intake Valve (1pc.)
12	49460110	Exhaust Valve (1pc.)
13	49403400	Piston Ring
14	49403200	Piston
15	29717000	Piston Pin Retainer (2pcs./1pair)
16	49406000	Piston Pin
17	49405000	Connecting Rod
18	49403300	Cylinder
19	29122540	Cylinder Gasket
20	49401000	Crankcase
21	49466000	Push Rod (2pcs.)
22	45566310	Push Rod Cover "O" Ring (2pcs.)
23	49466100	Push Rod Cover (1pc.)
24	44564000	Cam Follower (2pcs.)
25	28310000	Lock Nut Set
25-1	28309000	Propeller Washer
26	49408000	Drive Hub
27	45520000	Thrust Washer
28	29431000	Crankshaft Ball Bearing (Front)
29	29030001	Crankshaft Ball Bearing (Rear)
30	45231100	Camshaft Bearing (1pc.)
31	49462000	Camshaft
32	44514110	"O" Ring
33	49401100	Cam Cover
34	49402000	Crankshaft
35	49402100	Crank Pin Stop Screw
36	29208200	Woodruff Key
37	29122540	Cover Gasket
38	49407000	Cover Plate
39	49407010	PCV Valve Set
40	74002320	Rotation Sensor
40-1	74002321	Rotation Sensor Retaining Screw Set (2pcs.)
41	49469450	Thermo Insulator
42	49414010	Intake Manifold Gasket (2pcs.)
43	49469400	Intake Manifold
44	49415010	Carburetor Gasket Set
45	49481000	Carburetor Complete (WT1070)
45-1	29781360	Choke Arm Assembly (1pc.)
45-2	29781350	N4-40x5 Screw (1pc.)
46	49412000	Velocity Stack
47	49425000	F-6040 Silencer Assembly
47-1	49425100	Silencer Body
47-2	44525110	Silencer Gasket (2pcs.)
47-3	44525200	Exhaust Header Pipe Assembly
47-4	44525210	Exhaust Header Pipe Nut M16 (1pc.)
	74002510	Ignition Module (IG-04)
	71669000	Spark Plug CM-6

The specifications are subject to alteration for improvement without notice.

**O.S. ENGINES MFG.CO.LTD.**

6-15 3-Chome Imagawa Higashisumiyoshi-ku  
Osaka 546-0003, Japan TEL. (06) 6702-0225  
http://www.os-engines.co.jp FAX. (06) 6704-2722

